

Reconnection Issues with Kestrel 5700 and Compatible Rangefinders

Note: Your Kestrel needs to have 1.45 or higher firmware and BLE Profile 0.9 or higher to use this app. Update your firmware with Kestrel LiNK Ballistics before doing this procedure.

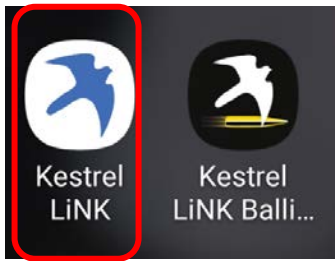

Download Kestrel LiNK on your Android or Mobile device. Note: not Kestrel LiNK Ballistics or Kestrel LiNK Legacy.

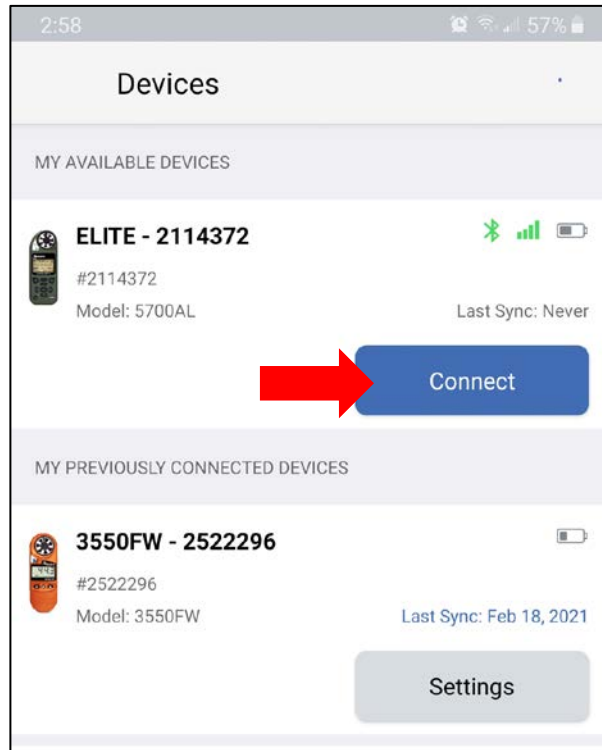

Select Connect when your Kestrel appears on the screen.

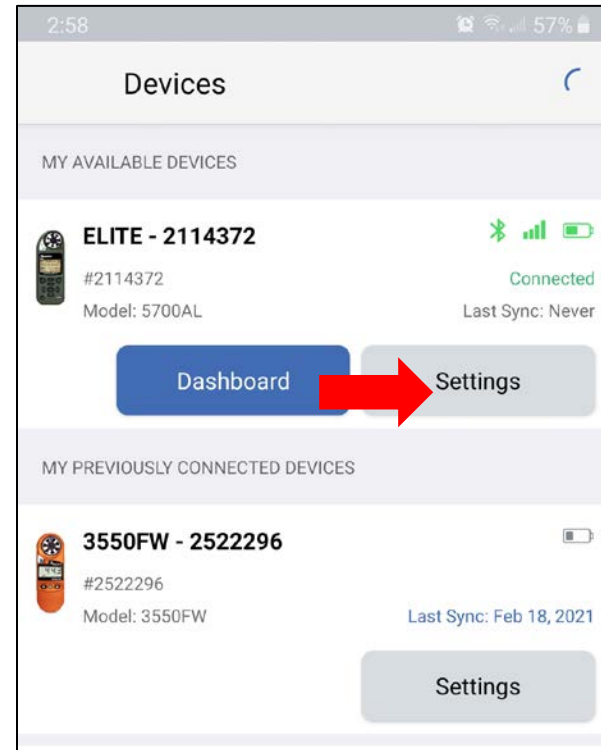

You will be taken to the dashboard, press back to go back to this screen. Select Settings.

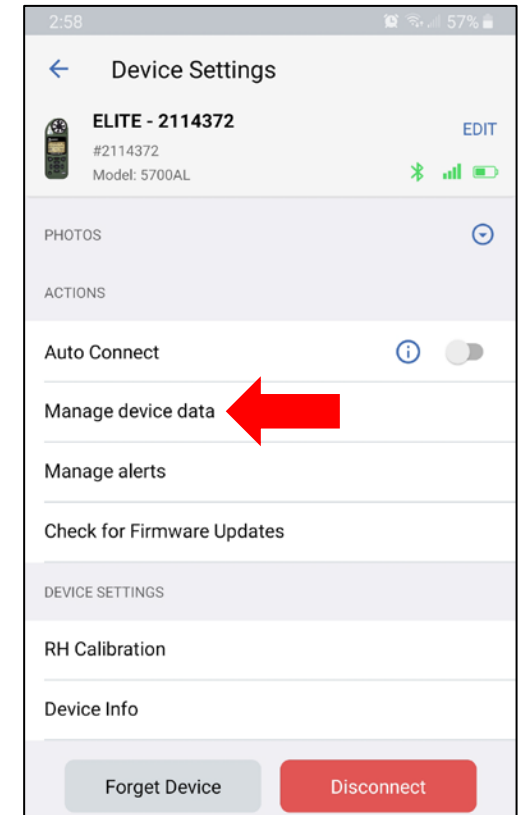

Select the Manage Device Data.

Reconnection Issues with Kestrel 5700 and Compatible Rangefinders

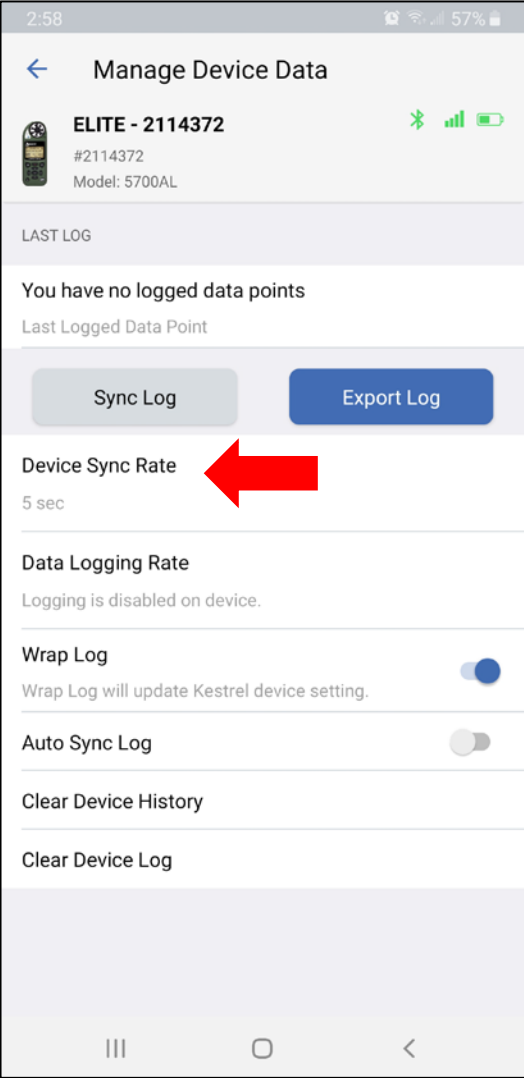

Select Device Sync Rate.

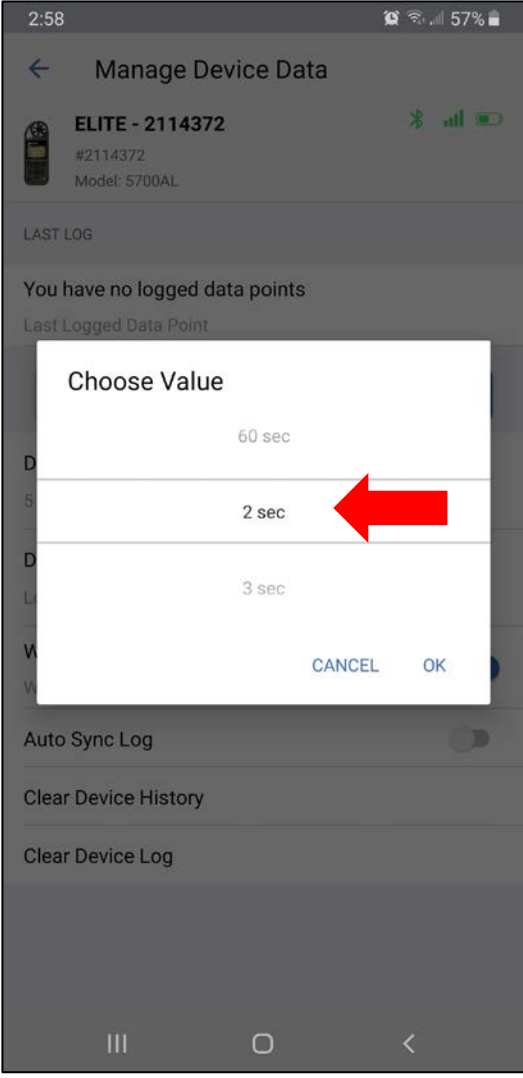

Set Rate to 2 seconds, and then OK.

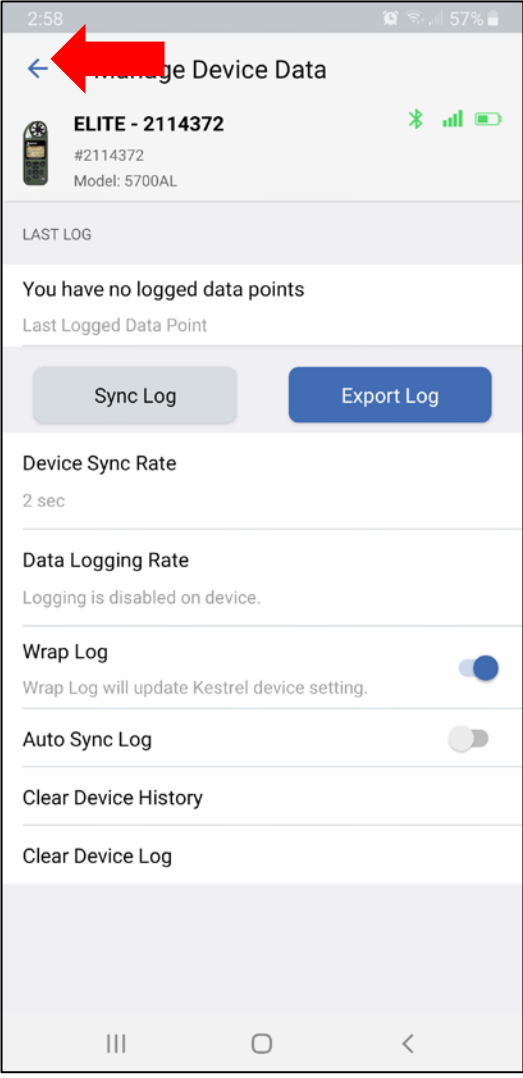

Hit the back arrow to exit out of this menu.

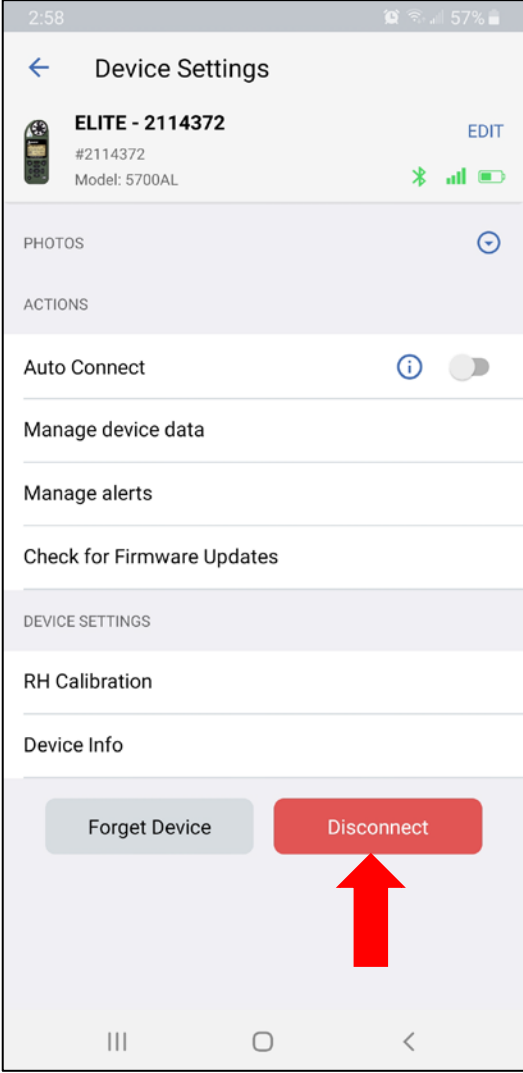

Select Disconnect.